



MADE IN CHINA
Manufactured by Eleaf™

Manufacturer: Shenzhen Eleaf Electronics Co., Ltd.
Address: Area B, 1-2F, B-28, Heyi Beifang Tech Industrial Park,
Shajing Town, Baoan District, Shenzhen, China.

Email: info@eleafworld.com
Web: www.eleafworld.com

Eleaf®



ELLO
Quick Start

How to Use?

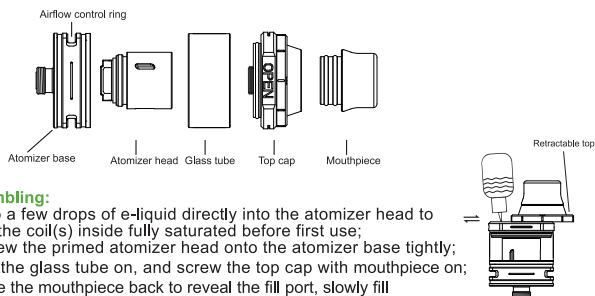

Assembling:

1. Drip a few drops of e-liquid directly into the atomizer head to make the coil(s) inside fully saturated before first use;
2. Screw the primed atomizer head onto the atomizer base tightly;
3. Put the glass tube on, and screw the top cap with mouthpiece on;
4. Slide the mouthpiece back to reveal the fill port, slowly fill

1 | ELLO | English

- e-liquid into the tank through the port, and then close the retractable top after filling.
(Note: please don't overfill.)
5. The airflow can be adjusted by rotating the airflow control ring on the atomizer base;
 6. Finally the ELLO is ready for use.



Warranty

We are not responsible for any damages caused by human error. Legal warranty is applied.

Warnings

1. Please keep out of reach of children.
2. This product is not recommended for use by young people, non-smokers, pregnant or breast-feeding women, or persons who are allergic/sensitive to nicotine.

English | ELLO | 2

Contra-indication

1. Do not attempt to repair the product by yourself as damage or personal injury may occur.
2. Do not leave the product in high temperature or damp conditions, otherwise it may be damaged.
3. Do not use this product for other purposes except only for vaping and don't swallow the e-liquid.

Possible Adverse Effects

1. This product may be hazardous to health and contains nicotine which is addictive.
2. For people with adverse reaction after using this product, it is recommended to use the e-liquid with lower nicotine content or no nicotine.

3 | ELLO | English