



TOTALLY WICKED®



OPAL

USER MANUAL

# YOUR OPAL

## YOUR OPAL KIT

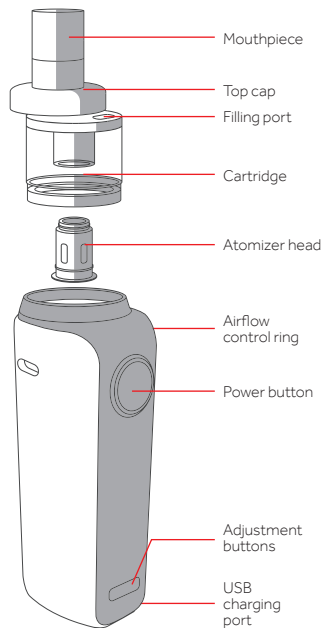

# OPAL

## QUICK START GUIDE

4



**REMOVE THE CARTRIDGE**

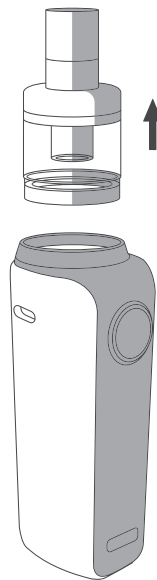

**OPAL**

5

## PRIME THE ATOMIZER HEAD

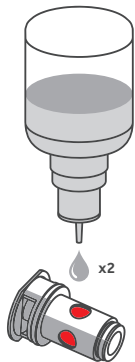

## FIT THE ATOMIZER HEAD

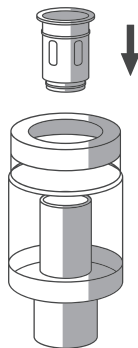

Wait 5 minutes before vaping  
a new atomizer head.



## REATTACH THE CARTRIDGE



## FILL THE CARTRIDGE

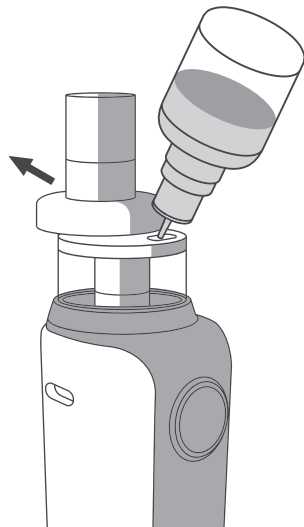

Push and slide the top cap where marked to reveal the filling port. Insert e-liquid nozzle and fill.





## ADJUST AIRFLOW

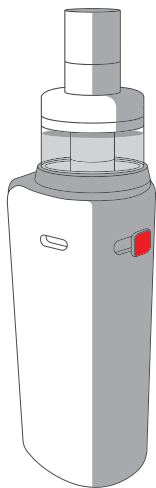

## TURN POWER ON

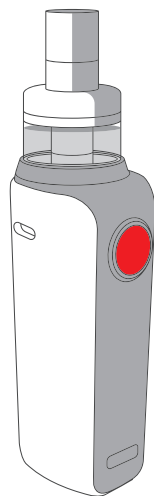



## SET WATTAGE

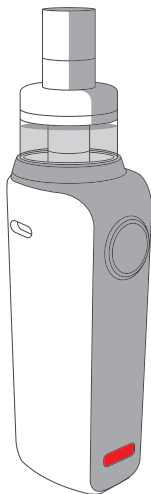

Press the up or down buttons to adjust the power.

## VAPING

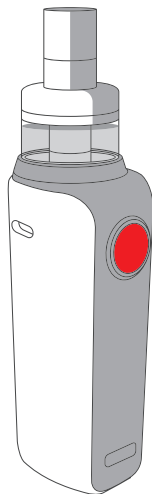

Press and hold to vape.



## CHARGE THE BATTERY

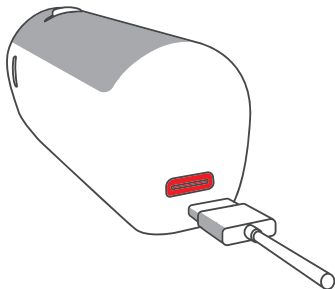

## USING YOUR OPAL

### PRIMING THE ATOMIZER HEAD

It is important to "prime" a new atomizer head before first use. Failure to do so can damage the atomizer head. Take an atomizer head from the box and remove all packaging, drip a few drops of e-liquid onto the cotton inlets on the side of the atomizer head. Remove the cartridge from the battery by pulling upwards. Invert the cartridge and insert the atomizer head into the cartridge by pushing it into the recess at the base. Reattach the cartridge to the battery. After priming a new atomizer head, it is recommended to wait 5 minutes before vaping to ensure the atomizer head is fully saturated.

### ATOMIZER HEAD LIFESPAN

Atomizer heads do not last forever and need to be replaced periodically. Lifespan is generally from a few days to several weeks, depending on power used, vaping style, flavour and type of e-liquid. A slight burnt taste, general loss of vapour production, or a reduction in flavour intensity can all be indicators that the atomizer head requires replacement.







## USING YOUR OPAL

### FILLING THE TANK

Slide the top of the cartridge in the direction indicated by the arrow on the top cap to reveal the filling port. Insert your e-liquid bottle nozzle and fill. Close the cartridge by sliding the top back into place.

**Note:** To avoid air-locks, ensure an air gap of 2mm remains above the e-liquid after filling. After priming a new atomizer head and filling the cartridge, wait 5 minutes to ensure the atomizer head is fully saturated.

### POWERING ON AND OFF



Press the power button 5 times in quick succession to turn the Opal on. Pressing the power button 5 times quickly will turn the device off again.

### SETTING THE WATTAGE

The Opal has adjustable wattage that can be set from 10-25W in increments of 2 or 3W. Use the adjustment buttons on the battery to increase or decrease the wattage.

The GTL 0.8ohm atomizer heads provided perform the best between 10W – 21W, with the optimum power being 17W.

### VAPING

Press and hold the power button and inhale through the mouthpiece. The device will begin to produce vapour.

### ADJUSTING THE AIRFLOW



To adjust the airflow to your personal preference, slide the airflow control switch located on the battery. The more area exposed on the side of the device, the more open the air draw will be. Sliding the airflow switch to the left will allow for a more open air draw, and sliding it to the right will restrict the airflow draw.





## USING YOUR OPAL

### E-LIQUID LEVEL

To prevent the atomizer head from becoming dry and burning prematurely, ensure the e-liquid level does not drop below the e-liquid inlets on the atomizer head, visible through the cartridge.

### CHARGING THE BATTERY

To charge the battery, connect the charge port on the battery to a USB port or suitable wall adaptor using the charging lead supplied. The LED will glow red until fully charged, at which point it will turn off.



### REPLACING THE ATOMIZER HEAD

Remove the cartridge from the battery and invert. Remove the atomizer head from the cartridge by pulling, then insert a new atomizer head. Before fitting a new atomizer head, remember that it will need priming as described in the section "Priming the Atomizer Head".

**Reminder:** After priming a new atomizer head, it is recommended to wait 5 minutes before vaping to ensure the atomizer head is fully saturated.

### BATTERY LIFE INDICATION

The colour of the LED below the power button will change dependant on the level of remaining charge the Opal has. The table below displays what battery percentage each colour indicates.



Colour of LED	Battery Level
Green	100% - 60%
Blue	59% - 20%
Red	≤ 20%





## PROTECTIONS

### ATOMIZER HEAD PROTECTION

If the power button is held down for longer than 10 seconds while vaping, the LED light below the button will flash 5 times and the Opal will refuse to power or produce any vapour. Releasing the power button will allow normal operation to resume.

### LOW VOLTAGE PROTECTION

If the battery voltage drops below 3.3V, the LED will flash 20 times and the Opal will not produce vapour. Charge the battery using the steps outlined in "Charging the Battery" to allow normal operation to resume.



### SHORT CIRCUIT PROTECTION

If a short circuit occurs before vaping, the LED will flash 5 times in quick succession, the device output will be stopped. If a short circuit occurs during vaping, the LED will flash 3 times in quick succession. To restore normal vaping, follow the steps outlined in "Replacing the atomizer head" to allow normal operation to resume.

### NO ATOMIZER DETECTED PROTECTION

If no atomizer head is detected, the LED will slowly flash until the button is released, and the Opal will refuse to power or produce any vapour. Ensure the atomizer head is securely fitted into the cartridge base. If this error condition continues, following the steps outlined in "Replacing the Atomizer Head" should allow normal operation to resume.





## CLEANING AND MAINTENANCE

Clean the Opal battery and cartridge connection by wiping down with tissue or a dry cloth. The cartridge can be cleaned by removing it from the battery, and removing the atomizer head. Clean the cartridge under warm running water. Allow the cartridge to dry thoroughly before refitting the atomizer head into the cartridge.

**Note:** Do not attempt to clean the atomizer head with water. Do not submerge the Opal battery unit in water or allow it to get wet.



## KIT CONTENTS

- 1 x Opal battery
- 1 x GTL Cartridge
- 2 x GTL 0.8ohm atomizer heads
- 1 x USB-C cable
- 1 x User manual

## SPECIFICATIONS

- Dimensions: 102mm (length) x 25mm (width) x 31mm (depth)
  - Weight: 61g
  - Battery Capacity: 1500mAh
  - Wattage Range: 10-25W
  - Maximum Charging Current: 2.0A
  - Atomizer Resistance Compatibility: 0.25 – 3.0ohm
  - Thread type: Proprietary connection
- 







## ADDITIONAL PRODUCT INFORMATION

There are no reported medical side effects with this product. If you believe you experience a side effect, please contact the manufacturer.

## WARNING



This product contains magnets. If you have an ICD or pacemaker, avoid close or prolonged contact with pods that are not fitted into the battery, and keep the assembled device at least 15cm from where your device is implanted.



## PRODUCT STORAGE AND BATTERY PRECAUTIONS



- Store the Opal e-cigarette and its accessories away from children whilst not in use.
- Please charge using only the cable provided, or a genuine TW accessory.
- Please dispose of dead batteries in accordance with your country's appropriate legislation.
- Do not charge the battery in a damp environment, or in temperatures under 0°C or above 45°C.
- Do not use the device in temperatures under -10°C or above 60°C.
- Do not carry batteries in a pocket or bag with other metallic objects.
- Do not attempt to repair a faulty Opal battery as these are sealed units with no serviceable parts. Attempted repairs will void the warranty.





## WARRANTY

The Opal has a 6 month parts warranty, with the exception of atomizer heads, which are consumable items and covered by "dead on arrival" warranty only. The USB cable supplied has a 12-month warranty. If any parts are found to be faulty within this time, please contact our customer service team, whose details are on the back page of this booklet, and we will arrange for a replacement. We may require the goods to be returned for further investigation.





**TO<sup>T</sup>ally w<sup>i</sup>cked<sup>®</sup>**

Manufactured in China under the authority of  
Pillbox38 (UK) Ltd, Stancliffe Street,  
Blackburn, Lancashire, BB2 2QR.  
Tel: 01254 692244  
[www.totallywicked.co.uk](http://www.totallywicked.co.uk)



**UK  
CA**



**18+**