

PRODUCT INFORMATION

ATOMIZER HEAD RANGE : CS

VIDEO LINK Click [HERE](#) to review the video accompanying this information.

CS atomizer heads form the most popular range of atomizers sold by Totally Wicked; the CS 1.5ohm is our single most popular atomizer head. The range provides an outstanding vaping experience delivering great flavour and atomizer head lifespan. CS atomizers are best suited to regular vapers.

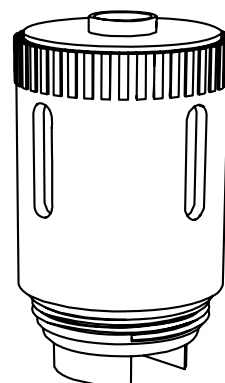

AVAILABLE RESISTANCES, COIL MATERIAL AND PREFERRED POWER LEVELS

Resistance (ohms)	Coil Material	Wicking Material	Ideal Power (watts)	Power Range (watts)
CS-M 0.6	Kanthal	Natural Cotton	17.5	8 - 22
0.75	Nickel-Chrome	Natural Cotton	18	14.5 - 25
1.2	Nickel-Chrome	Natural Cotton	16	13 - 30
1.5	Nickel-Chrome	Silica	12	7 - 15
1.6	Stainless Steel	Natural Cotton	10.5	6 - 14
CS-M 0.35	Kanthal	Natural Cotton	30	12 - 50
0.15	Nickel	Natural Cotton	Temperature controlled atomizer head	
CS-A 0.8	AST Steel	Natural Cotton	11.5	7 - 16
CS-A 1.4	Kanthal	Natural Cotton	9	6 - 12

STANDARD ATOMIZER HEADS SUPPLIED WITH KITS AND TANKS:

arc 5 kit - 1.5ohm
arc Mini kit - 1.5ohm
arc Palm kit - 1.5ohm
arc Pico Baby kit - 1.5ohm, 0.75ohm
arc Slim kit - 1.5ohm
Aura kit - 1.5ohm
Resolve 2 kit - 0.75ohm
CS Air 2 tank - 1.5ohm
CS Air Baby tank - 1.5ohm
CS Air Slim tank - 1.5ohm
CS Aura tank - 1.5ohm
CS Micro tank - 1.5ohm
CS Resolve 2 tank - 0.75ohm
Slider CS Air tank - 1.5ohm
Eleaf Tance Max - 0.6ohm, 1.6ohm
Intu Pro Mini kit - 0.8ohm
CS Pro tank - 0.8ohm

FEATURES AND BENEFITS

- The CS 1.5ohm atomizer head delivers an outstanding vape experience and suits regular vapers who wish for their vaping experience to be reminiscent of smoking. This atomizer head is suitable for the vast majority of vapers.
- The CS 1.2ohm atomizer head has a greater airflow than the 1.5ohm atomizer head and can be used at higher powers. For vapers looking for greater vapour production whilst retaining excellent battery life the CS1.2ohm atomizer head should be recommended
- The CS 0.75ohm atomizer head has a greater airflow and higher power than the CS 1.5ohm atomizer head which may not appeal to all vapers, but is recommended to vapers looking to increase vapour production.
- Working power range of between 7 and 50 watts.
- The CS-M 0.35ohm atomizer head has the greatest vapour production of the range and is a good upgrade for arc 5 and arc Palm users looking for increased vapour production.
- The CS 1.6ohm atomizer head provides a good MTL experience at a slightly lower wattage than the CS 1.5ohm.
- The CS-A 0.8ohm atomizer head offers a dry burn protection feature, achieved through its AST Steel coil material. Currently, this is only compatible with the Intu Pro Mini when 'AST Dry-Proof' mode is enabled.

COMPATIBILITY

- All nickel-chrome atomizer heads are compatible with power, bypass, variable voltage and smart modes.
- The CS-Ni 0.15ohm nickel atomizer head will fit any tank which accepts a CS atomizer head but can only be used with devices which support temperature controlled vaping.
- The arc Mini requires a minimum resistance of 1.0ohm.
- The CS-M is compatible with the arc 5 and arc Palm only.

PRODUCT INFORMATION

ATOMIZER HEAD RANGE : CS

CS ATOMIZER HEADS

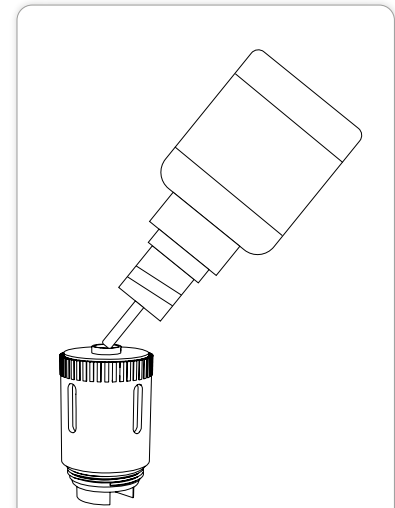
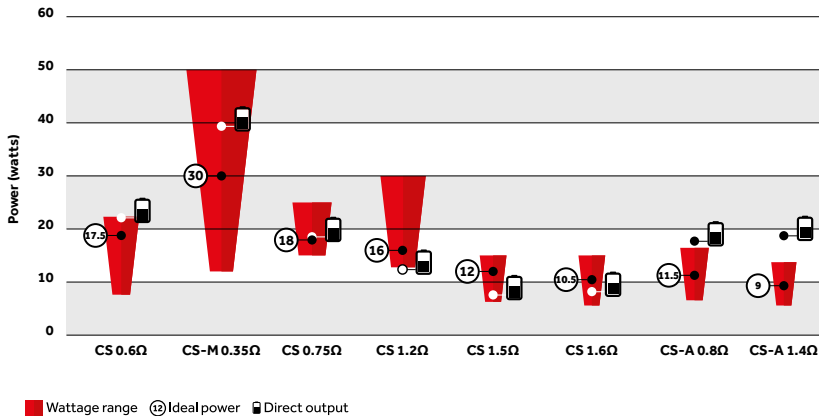

PRIMING

CS atomizer heads are primed by dripping a few drops of e-liquid into the central hole.

After priming a new atomizer head and filling the tank, it is recommended to wait 5 minutes before vaping to ensure the atomizer head is fully saturated.

ADDITIONAL NOTES

- The CS 1.2ohm atomizer head is suitable for vapers using variable power devices looking for increased vapour production.
- If the airflow of an atomizer head is too great this can be reduced by adjusting the airflow of the tank (on tanks with airflow control).
- The amount of vapour produced by a Resolve 2 kit can be reduced by replacing the supplied CS 0.75ohm atomizer head with the CS 1.5ohm.
- The arc Mini outputs significantly more power than it displays on screen, this is especially true when lower wattages are selected. For example the arc Mini set to output 6 watts will actually deliver 10 watts. Advise customers to use lower power settings than with other variable wattage devices.
- The CS-A 1.4ohm atomizer head, whilst offering a similar resistance to the 1.5ohm, uses a different orientation and wicking material, allowing for better use with top-filled CS tanks. This is achieved by using a vertical coil arrangement.